

Analyses Management

The Analyses screen helps you manage the application analyses of your account.

- [Query Analyses](#)
- [Navigate to results](#)
- [Delete one analysis](#)
- [Bulk deletion of analyses](#)
 - [Delete matching filter analyses](#)
 - [Delete handpicked analyses](#)

In the top-right corner of the screen, click the drop-down icon, select **Application Management**, and access the **Analyses** option.

ANALYSES

Analysis code

Application

Requested by

Scope

Label

State

Date from

Date to

Apply

Clear

50 of 123

Bulk change

| Analysis code | Application | Creation date | Finish date | State | Available data | Scope | Label | Requested by |
|-------------------|-------------|------------------|------------------|---------|---|-------------------|-----------------|--------------|
| A-7e4-172b7f151e5 | tachiyomi | 2020/06/15 16:11 | 2020/06/15 16:12 | Success | <div>SECURITY</div> <div>ANALYSIS</div> | Complete delivery | 2020-06-15_1611 | sysadmin |
| A-7e4-172b7f151e4 | tachiyomi | 2020/06/15 16:10 | 2020/06/15 16:11 | Success | <div>SECURITY</div> <div>ANALYSIS</div> | Partial delivery | 2020-06-15_1610 | sysadmin |
| A-7e4-172b7f151e3 | tachiyomi | 2020/06/15 16:09 | 2020/06/15 16:10 | Success | <div>SECURITY</div> <div>ANALYSIS</div> | Complete delivery | 2020-06-15_1609 | sysadmin |
| A-7e4-172b7f151e2 | tachiyomi | 2020/06/15 16:08 | 2020/06/15 16:09 | Success | <div>SECURITY</div> <div>ANALYSIS</div> | Partial delivery | 2020-06-15_1608 | sysadmin |
| A-7e4-172b7f151dd | tachiyomi | 2020/06/15 16:04 | 2020/06/15 16:04 | Success | <div>SECURITY</div> <div>ANALYSIS</div> | Baseline | 2020-06-15_1604 | sysadmin |
| A-7e4-172b7f151d9 | tachiyomi | 2020/06/15 16:00 | 2020/06/15 16:01 | Success | <div>SECURITY</div> <div>ANALYSIS</div> | Complete delivery | 2020-06-15_1600 | sysadmin |
| A-7e4-172b7f151d8 | tachiyomi | 2020/06/15 15:59 | 2020/06/15 16:00 | Success | <div>SECURITY</div> <div>ANALYSIS</div> | Baseline | 2020-06-15_1559 | sysadmin |
| A-7e4-172b7f151d7 | tachiyomi | 2020/06/15 15:58 | 2020/06/15 15:59 | Success | <div>SECURITY</div> <div>ANALYSIS</div> | Complete delivery | 2020-06-15_1558 | sysadmin |

Query Analyses

The Analyses screen allows you to filter the analysis subset you want to view.

Analysis code

Application

Requested by

Scope

Label

State

Date from

Date to

WebGoat

victama

Baseline

Complete delivery

Partial delivery

Select all

Clear

Apply

Clear

The available fields are the following:

- **Analysis code:** Type part or the whole analysis code.
- **Application:** Type part or the whole application name.
- **Requested by:** The person who executed the analysis. You can select the users you want from the expanded username list.
- **Scope:** Select one or several options, such as Baseline, Complete delivery, or Partial delivery.
- **Label:** Type part or the whole analysis label.
- **State:** Select one or several options, such as Success, Fail, or In Progress.
- **Date from** and **Date to:** Enter the date range of the analysis list you want to retrieve.

After entering all filter values, click **Apply** to see the results of the query.

Navigate to results

When successful analyses are retrieved, the Available data column displays different tags. Click a tag to redirect you to the results of the analysis.

11 of 11

| Analysis code | Application | Creation date | Finish date | State | Available data | Scope |
|-------------------|------------------------|------------------|------------------|---------|----------------------------|---------------------------------------|
| A-7e4-172a3043c7f | tachiyomi | 2020/06/11 12:55 | 2020/06/11 12:57 | Success | INSIGHTS | Complete delivery |
| A-7e4-172a3043c7e | tachiyomi | 2020/06/11 12:54 | 2020/06/11 12:55 | Success | SECURITY ANALYSIS | Partial delivery |
| A-7e4-1723c6f9692 | SAS-5198 | 2020/05/22 14:50 | 2020/05/22 14:50 | Success | SECURITY ANALYSIS | Baseline |
| A-7e4-1723c0b73ba | tachiyomi | 2020/05/22 13:00 | 2020/05/22 13:01 | Success | SECURITY ANALYSIS | Baseline |
| A-7e4-171eee8f2fe | WebGoat-7.1-Insights-2 | 2020/05/07 13:32 | 2020/05/07 13:33 | Success | INSIGHTS | Baseline |
| A-7e4-171cba66605 | WebGoat-7.1-Insights | 2020/04/30 17:12 | 2020/04/30 17:14 | Success | SECURITY ANALYSIS INSIGHTS | Baseline |
| A-7e4-1712b41c288 | Symfony.VarDumper | 2020/03/30 16:17 | 2020/03/30 16:18 | Fail | | Click to navigate to Insights results |
| A-7e4-1712b41c287 | Symfony.VarDumper | 2020/03/30 16:06 | 2020/03/30 16:07 | Success | SECURITY ANALYSIS | Baseline |
| A-7e4-1712b41c286 | Symfony.VarDumper | 2020/03/30 15:56 | 2020/03/30 16:04 | Success | SECURITY ANALYSIS | Baseline |
| A-7e4-1712b41c285 | symfony | 2020/03/30 13:58 | 2020/03/30 14:04 | Success | SECURITY ANALYSIS | Baseline |
| A-7e4-1712b41c284 | symfony | 2020/03/30 13:39 | 2020/03/30 13:45 | Success | SECURITY ANALYSIS | Baseline |

Delete one analysis

You can delete an analysis by clicking the drop-down icon on the right and selecting **Delete**. Confirm the deletion of the analysis in the confirmation dialog, the analysis is deleted, and the list is refreshed.

Requested by

sysadmin

▼

Delete

sysadmin

▼

sysadmin

▼

sysadmin

▼

sysadmin

▼

sysadmin

▼

Bulk deletion of analyses

You can perform a bulk deletion of analyses by following these steps:

1. On the top right corner, click the drop-down icon, and select **Delete**.

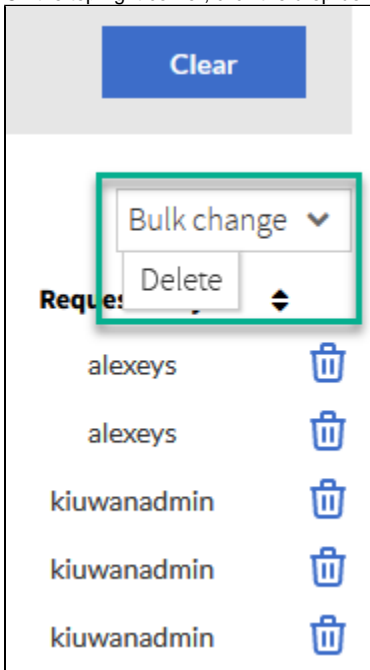

2. When the dialog box opens, select between:
 - a. Delete matching filter analyses
 - b. Delete a handpicked analyses.

Delete matching filter analyses

When you select **Delete** matching the current filter, the following dialog is displayed:

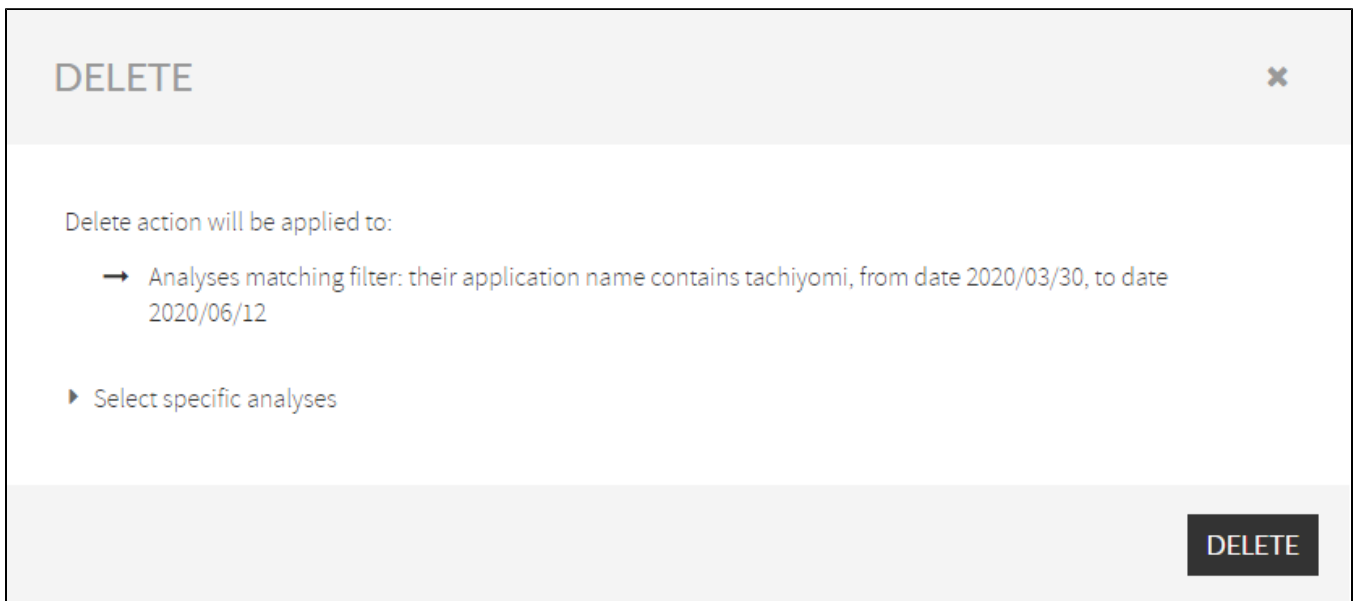

Click **Delete** to confirm the action, all the analyses that match the current filter are removed, and the analyses list refreshes.

Delete handpicked analyses

When you click **Select specific analyses**, the following dialog is displayed:

DELETE

×

Delete action will be applied to:

→ Selected analyses in the list.

▼ Discard current analysis selection

3 of 3

| | Analysis code | Application | Creation date | State | Scope | Label |
|-------------------------------------|-------------------|-------------|------------------|---------|-------------------|-------------|
| <input checked="" type="checkbox"/> | A-7e4-172a3043c7f | tachiyomi | 2020/06/11 12:55 | Success | Complete delivery | dlv03comp02 |
| <input checked="" type="checkbox"/> | A-7e4-172a3043c7e | tachiyomi | 2020/06/11 12:54 | Success | Partial delivery | dlv02part01 |
| <input type="checkbox"/> | A-7e4-1723c0b73ba | tachiyomi | 2020/05/22 13:00 | Success | Baseline | bl-01 |

DELETE

Select the analyses you want to delete, click **Delete**, and validate the action when the confirmation dialog box opens.